

VIVA 3 cabinet loudspeaker

Package contains:

| | |
|-------------------|--------|
| Loudspeaker | 1 pcs. |
| Bracket | 1 pcs. |
| Decorative cover | 1 pcs. |
| Phoenix connector | 1 pcs. |

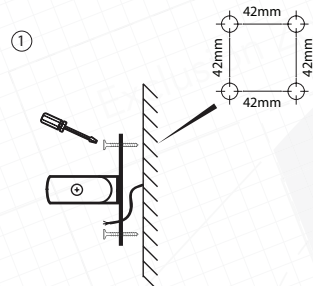

① Drill four holes according to the drawing.
Distance between the mounting points - 42 mm.

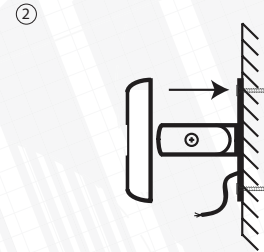

② Fix the loudspeaker bracket on the wall with fasteners suitable for your wall type. Place decorative cover on the bracket.

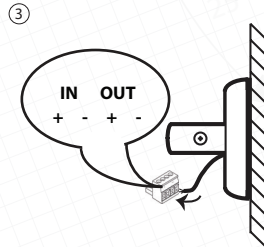

③ Connect audio cable to Phoenix connector.

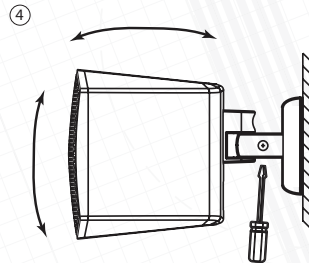

④ Place loudspeaker to the bracket and adjust vertical and horizontal angle. Tighten the bracket's screw.

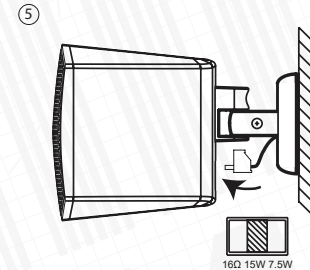

⑤ Connect Phoenix connector to socket.
Set the desired loudspeaker power tap.

Please pay attention: Mount loudspeaker on the reliable base only.